

## Quick Installation Guide

### Router Mode

If your internet connection is through an Ethernet cable directly from the wall instead of through a DSL/Cable/Satellite modem, connect the Ethernet cable to the router's WAN port, then follow step 4 and 5 to complete the hardware connection.

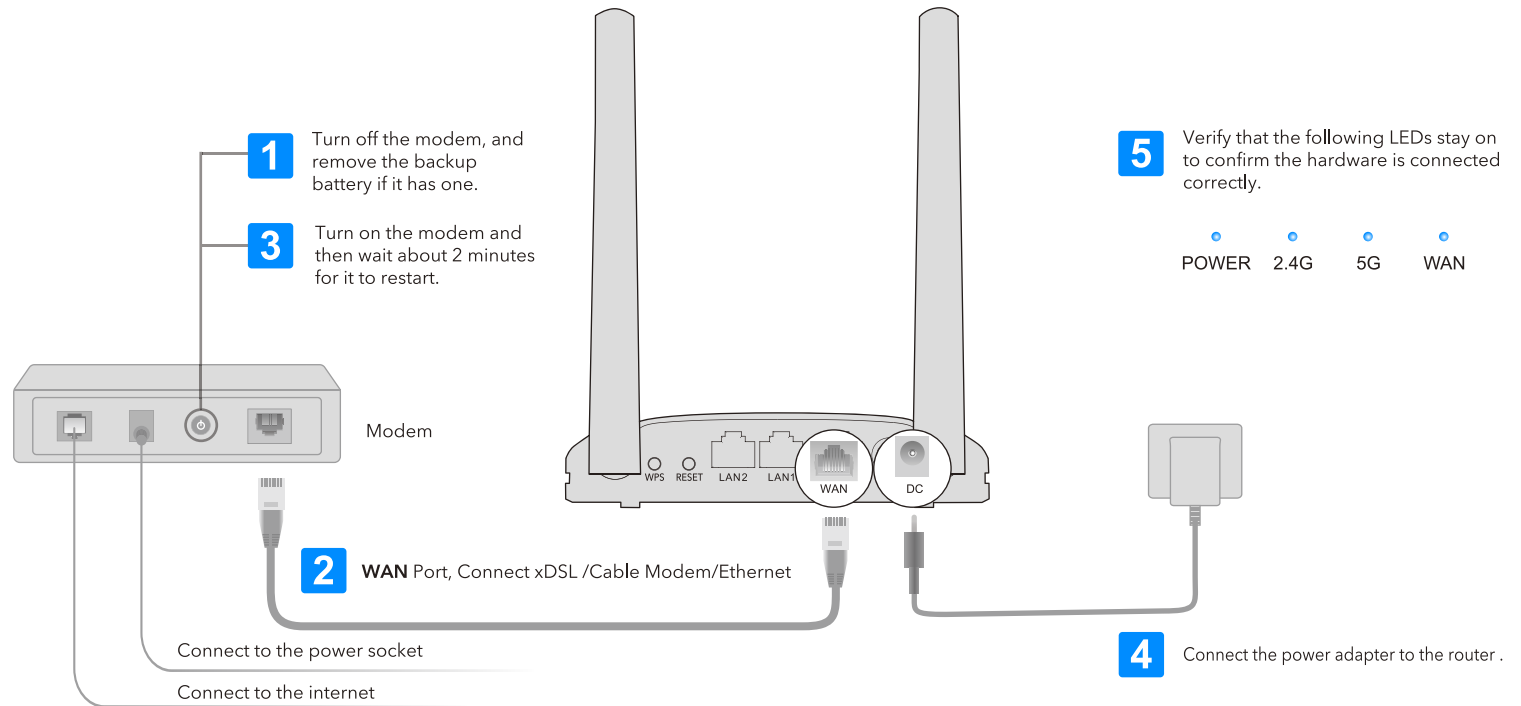

## 6

### Configure the router

1. Connect your computer to the router (Wired or Wireless)

#### Wired

Turn off the Wi-Fi on your computer and connect it to the LAN port of Cudy router via an Ethernet cable.

#### Wireless

Connect your device to the router's Wi-Fi using the SSID (network name) and SSID Password printed on the label at the bottom of the router.

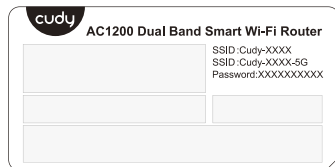

2. Launch a web browser, and enter <http://cudy.net> in the address bar. Use **admin** for password to log in.

Note: If the login window does not appear, please refer to FAQ > Q1.

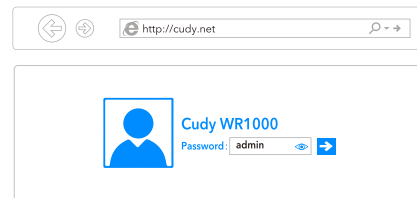

3. Then the following page will pop up automatically, if you are not sure of the WAN Connection Type, please click **Auto-Detect**. Or you can **Select WAN Type Manually**.

Note:  
1. If the following page not pop up, click **Home->Network->WAN**.  
2. The WAN Connection type can be got from your ISP.

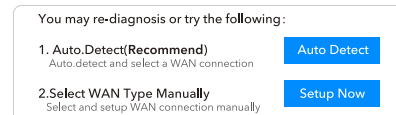

4. For DHCP connection type, just click to connect button, shown as (4-1). For PPPoE, you need to input the account and password that ISP provide, shown as(4-2). For Static(Fixed IP), you need to configure the following information which provided by the ISP, shown as (4-3).

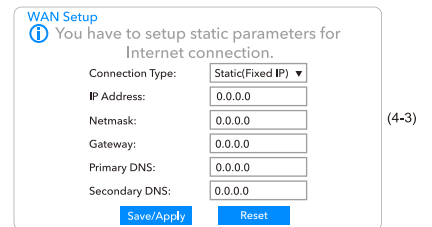
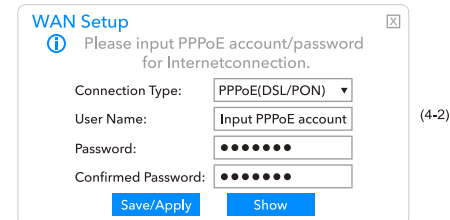
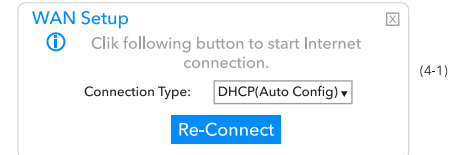

5. Shows the interface as below means setting successful.

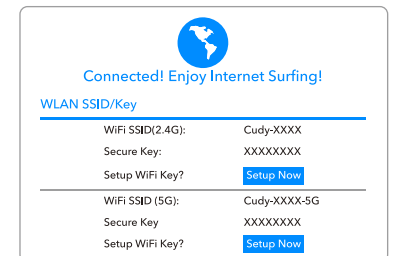

# Range Extender Mode

1

## Configure

1. Place the router next to your host router and power it on.
2. Connect a computer to the LAN port of Cudy router via an Ethernet cable or wirelessly by using the SSID (network name) and SSID Password printed on the label at the bottom of the router.
3. Launch a web browser and enter **http://cudy.net** in the address bar. Use **admin** for password to log in.

You may re-detect or try the following:

### 1.Ethernet

Insert Ethernet cable into the WAN port for Internet connection

### 2.WiFi Repeater

Click "Site Survey" to scan and associate a WiFi AP

Site Survey

2

In the dialog box, choose "on" of the Range Extender, then choose the network you want to extend and enter the Wi-Fi Password, and click "Save/Apply".

WiFi Repeater Settings

You may stop the survey or try again

WiFi repeater: ☐

Select SSID:

00:00:00:00:00:00

Current SSID:

Save/Apply

Re-Scan

3

Wait for a moment, when the following pages appears, it means "it's successful".( Please be noted: if it doesn't work, please repeat the last two steps.If signals can't be scanned, you can check the status of the main router, or if it is too far from the main router, cause the signal too weak.)

Connected! Enjoy Internet Surfing!

WLAN SSID/Key

WiFi SSID(2.4G): Cudy-XXXX

Secure Key: XXXXXXXX

Setup WiFi Key? 

Setup Now

WiFi SSID (5G): Cudy-XXXX-5G

Secure Key: XXXXXXXX

Setup WiFi Key? 

Setup Now

## Note

Place the router about halfway between your host router and the Wi-Fi "dead" zone. The location you choose must be within the range of your existing host network.

## Button Explanation

BUTTON	DESCRIPTION
WPS	Press and hold for 1 second to enable the WPS function.
Reset	Press and hold this button for about 2 seconds to reset the router to its factory default settings.

## More Features

Cudy router supports various features. You can log in to the router's web management page at **http://cudy.net** to configure these functions.

## Support

For technical support, user guide and more information, please visit:  
<http://www.cudytech.com/support>.  
E-Mail: [support@cudytech.com](mailto:support@cudytech.com)

## Frequently Asked Questions (FAQ)

**Q1: What can I do if the login window does not appear?**

**A1:** If the computer is set to a static IP address, change its settings to obtain an IP address and DNS server address automatically.

**A2:** Verify that **http://cudy.net** (or **http://192.168.10.1/**) is correctly entered in the web browser .

**A3:** Use another web browser and try again.

**A4:** Reboot your router and try again.

**A5:** Disable and then enable the network adapter being used.

**Q2: What should I do if my handy can not find Wi-Fi signal?**

**A:** Please make sure the router is connected, power and broadband interface has no loose. If everything is normal but still no signal, please try to use computer to set, or restore the router to factory settings. If after restoring factory settings but still no signal, you can restart the router, if it still doesn't work, maybe the router has fault.

**Q3: How to Reset to defaults?**

**A:** While the power is still on, keep pressing the reset button for 2 seconds, and wait for 1-2 minutes and it will restore to factory settings. (Please be noted: After restoring the factory settings you need to reset again.)

**Q4: Why cannot my phone enter the Setting Page of Router?**

**A:** Please make sure your Phone is connected to the Cudy Router Wi-Fi(Please follow instructions on 6.1) And make sure you enter the right site in the browser. (Please follow instructions on 6.2)

**Q5: Why cannot I enter the Setting Page of Router after restarting the Router?**

**A:** After restarting the Router, maybe your phone connect automatically to other Wi-Fi, please make sure your phone is connected to Cudy Router Wi-Fi. (Please follow instructions on 6.1)

**Q6: What should I do if I forget the Wi-Fi password or the username and password of the Login settings Page?**

**A:** Restore factory settings, and then reset the router.



810600013